

# Baby Anne

Directions for Use Page 2 – 5



**Laerdal**  
helping save lives

## Contents

Limited Warranty.....	2
Service .....	2
Introduction.....	3
Unpacking.....	3
Packing .....	3
Instructions for use and maintenance .....	4
Assembly.....	4
Foreign body practice.....	4
Sanitation .....	5
Specifications.....	38

## Limited Warranty

Laerdal warrants to the purchaser that its product(s) is/are free from defects in material and workmanship for a period of one (1) year from the date of the original purchase. If the purchaser notifies Laerdal in writing of a defect in material or workmanship, and ships the defective product to Laerdal within the designated one (1) year period, Laerdal will, at its own option, repair or replace any parts found to be defective, or the entire product.

Products found to be defective and notification of defects may also be sent to the authorized Laerdal Medical dealer from whom the product was purchased. All postage, shipping, or handling charges shall be the sole responsibility of the purchaser.

Laerdal Medical is responsible for the effects of safety, reliability and performance of its product(s) only if:

- service, repair, readjustment or modification is carried out by Laerdal Medical or persons authorized by Laerdal Medical
- the product is used in the proper manner in strict compliance with its Directions for Use.

Laerdal Medical shall not be liable under this warranty for incidental or consequential damages if unauthorized repairs or modifications have been made or attempted or when the product, or any part thereof, has been damaged by accident, misuse or abuse.

This warranty does not cover batteries, fuses, normal wear and tear, staining, discoloration or other cosmetic irregularity which does not impede or degrade product performance.

Some states in the USA do not allow the exclusion or limitation of incidental or consequential damages, so those limitations or exclusions may not apply to you.

There are no other express or implied warranties, whether of merchantability, fitness or purpose, or otherwise, on the product, its parts and accessories.

## Service

The Baby Anne Infant CPR Trainer consists of several main components where all replaceable parts are field serviceable. Spare parts are identified on the exploded view diagram and parts list.

Since the Baby Anne manikin is easy to disassemble and reassemble, all maintenance and repairs can be accomplished by the manikin's owner. Should a problem arise, however, we will be glad to assist you.

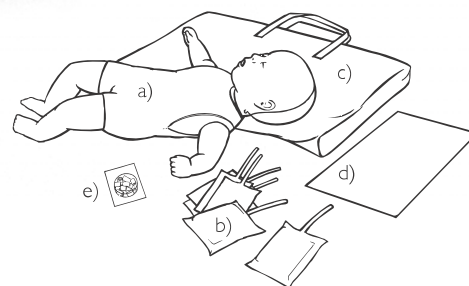

## Introduction

Baby Anne has been developed to provide a cost effective alternative for paediatric CPR training programmes. More manikins can be used in the classroom, increasing hands-on practice and active participation for the students. All of the necessary educational requirements are included to assure quality training. Baby Anne is also ideal as a training manikin for people who want to refresh their CPR skills, either between courses or in home training programmes.

Baby Anne simulates an infant three months of age, with average physiology and anatomy, and is designed for realistic training of basic life support (BLS) skills, primarily cardiopulmonary resuscitation (CPR) and relief of foreign body airway obstruction.

Some helpful features included in the Baby Anne manikin for effective training:

- Natural obstruction of the airway
- Realistic facial features and a movable jaw
- Human-like compliance for ventilations and compressions
- Chest rise with ventilations
- Realistic landmarks for compression point location
- Simulation of choking/foreign body airway obstruction, enabling training of full infant CPR protocol.

## Unpacking

The single pack Baby Anne manikin is supplied with:

- a) Baby Anne manikin
- b) 6 Baby Anne airways
- c) Carrying bag
- d) Directions for Use
- e) 10 objects which simulate foreign bodies for airway obstruction training.

The 4-pack Baby Anne manikins are supplied with one Bag and one copy of the Directions for Use, otherwise the same accessories per manikin as listed above.

## Packing

Do not store the manikin with the disposable airway installed, as prolonged closing of the airway tubing may cause a permanent deformation.

When packing the 4-pack, position the manikins as illustrated.



## Instructions for use and maintenance

### Assembly

*Important:*

*Baby Anne is shipped without the airway installed. You will need to install the Baby Anne airway prior to use.*

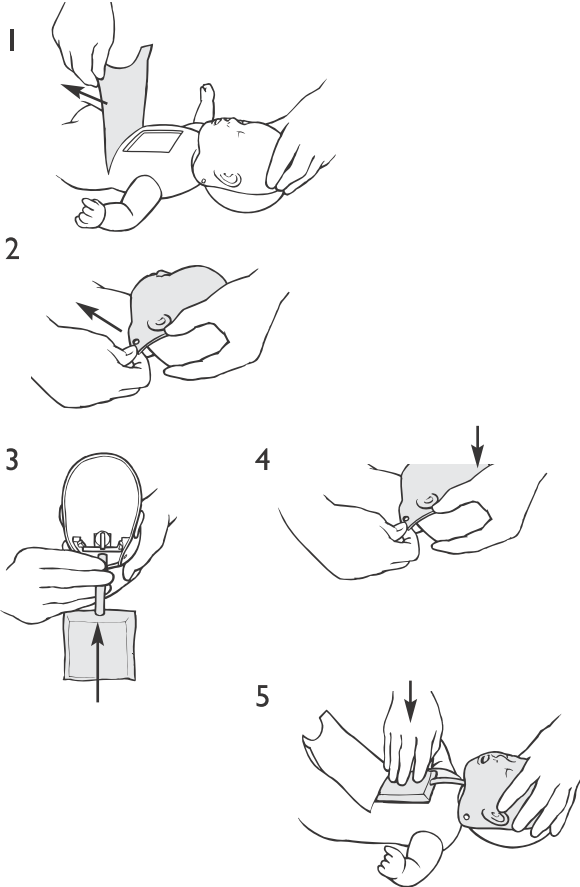
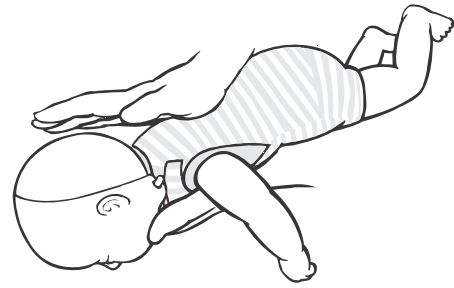

1. Open the chest cover.
2. Remove face mask assembly by unhooking the mask from the 2 pegs at the back of the skull.
3. Install an airway by pressing the airway tubing onto the face connector. Align the lung with the face mask.
4. Reinstall the face mask/ airway assembly. Guide the pins on the jaw into the matching slots in the skull.
5. Position the lung into the chest cavity. Make sure the airway tubing is not bent or kinked. Close the chest cover.

### Foreign Body practice

Baby Anne allows you to practise the procedure for relieving foreign body airway obstruction. Compression of the lung bag with adequate force will cause the foreign body practice object to be expelled from the face connector. Hence, both back blows and chest thrusts can be practised.

*Important: Please note that the airway must remain open with head tilt while performing the procedure of removal.*

After completing a removal sequence, inspect to see whether the practice object has been expelled into the mouth cavity. If loose, use finger sweep technique to remove the object. If inspection and further advances in the procedure reveals that the airway is still blocked, repeat the sequences.



### How to install "Foreign Body Practice Object"

Insert the practice object into the cavity in the face connector with one of the flat ends first.

*NOTE: Take care not to deform the object by squeezing or otherwise applying excessive force.*

The manikin should only be used with the objects supplied. Other objects may not fit the manikin and not allow the training of the correct techniques.

*NOTE:*

*Take care to keep foreign bodies out of reach of children.*

### After class

After class a used foreign body practice object should be disposed of.

## Sanitation

### During class

We recommend that each student has his/her own manikin. If one Baby Anne is shared between several students during class, an individual face mask/airway assembly should be provided for each student.

In either case no cleaning is required until after class. Each student in the class should install and remove his or her manikin face.

### Installation of individual face mask/airway assembly

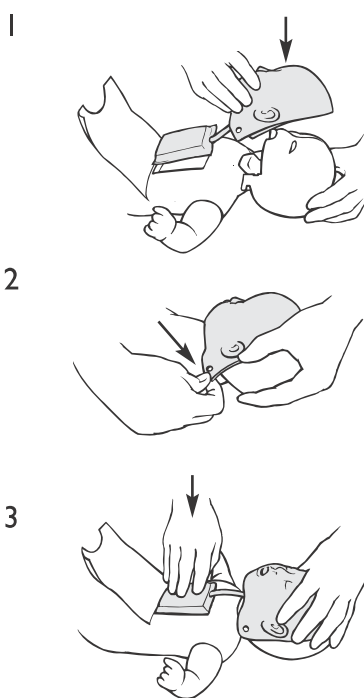

To remove

1. Open chest cover.
2. Unhook the face mask from the two pegs at the back of the manikin head.
3. Lift out face mask/airway assembly.

To install - page 4

### After class

After class a used manikin face can either be disposed of or cleaned and reused.

*Note: Wear rubber gloves\* during cleaning.*

1. Remove face mask/airway assembly:
  - a. Open chest cover.
  - b. Unhook face mask from the pegs at the back of the manikin head.
  - c. Lift out face mask and airway assembly.
  - d. Disconnect airway tubing from the face connector. Dispose of the airway only. Retain the other parts.

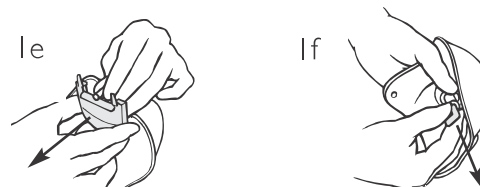

- e. Remove the jaw from the face mask assembly.
- f. Detach the face connector from the face mask.

2. Clean and disinfect face mask and face connector:
  - a. Wash with soapy warm water - scrub vigorously to remove dirt from interior surfaces.
  - b. Rinse with clean water to remove soap residue.
  - c. Disinfect the manikin face: A sodium hypochlorine solution, prepared for single class use, is an effective and recommended disinfectant. This solution should have at least 500 ppm free available chlorine - 1 part liquid household bleach to 100 parts tap water. Allow the parts to be fully submerged in the disinfecting solution for at least 10 minutes.\*\*
  - d. Rinse with clean water to remove disinfecting solution residues.

3. Allow parts to dry.



4. Reassemble Baby Anne for storage or transport:
  - a. Fit the face connector to the face mask. Note that the connector outlet should point downwards.
  - b. Fit the jaw to the face mask assembly.
  - c. Reinstall the face mask assembly on the manikin head. Take care to guide the pins on the jaw into the slots on the skull.
  - d. Close the chest cover.

### General manikin cleaning

Routine disinfection of the entire manikin is not required, but periodic cleaning of the head, body, overalls and carrying bag is recommended. Hard plastic parts should be wiped clean with warm water and soap, and then a rinse wipe with a clean damp cloth. Fabric-body should be cleaned with a damp cloth only, using mild detergent if necessary.

Take care not to expose the fabric body to excessive moisture, as this may penetrate the fabric and soak the manikin's stuffing. The overalls with the rib plate should be hand- or machine washed with soap or laundry detergent in warm water, max. 40°C (100°F). Please note that hot air dryer may cause garment shrinkage.

\* Vinyl gloves are recommended as latex gloves may stain face mask.

\*\* As recommended by JAMA, the American Heart Association, and Centres for Disease Control (CDC).