

Little Anne™ / AED Little Anne™

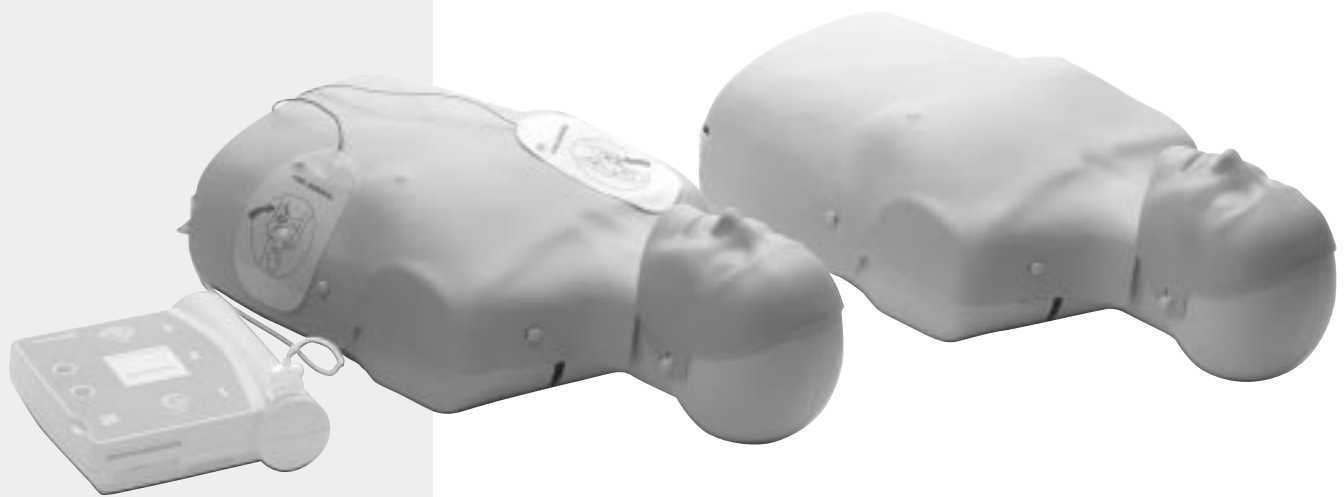

Laerdal
helping save lives

Limited Warranty

Laerdal Medical warrants to the purchaser that its product(s) is/are free from defects in material and workmanship for a period of one (1) year from the date of purchase by the original user. During the designated one (1) year period, Laerdal Medical will, upon receipt of a product found to be defective due to materials or workmanship from the purchaser and notification in writing of the defect at its option repair or replace any parts found to be defective or the entire product.

Products found to be defective and notification of defects may also be sent to the authorized Laerdal Medical dealer from whom the product was purchased. All postage, shipping, or handling charges shall be the sole responsibility of the purchaser.

Laerdal Medical is responsible for the effects of safety, reliability and performance of its product(s) only if:

- service, repair, readjustment or modification is carried out by Laerdal Medical or persons authorized by Laerdal Medical.
- the product is used in the proper manner in strict compliance with its Directions for Use.

Laerdal Medical shall not be liable under this warranty for incidental or consequential damages if unauthorized repairs or modifications have been made or attempted or when the product, or any part thereof, has been damaged by accident, misuse or abuse.

This warranty does not cover batteries, fuses, normal wear and tear, staining, discoloration or other cosmetic irregularity which does not impede or degrade product performance.

Some states in the USA do not allow the exclusion or limitation of incidental or consequential damages, so those limitations or exclusions may not apply to you.

There are no other express or implied warranties, whether of merchantability, fitness or purpose, or otherwise, on the product, its parts and accessories.

Service

Little Anne consists of several main components which have been designed to be durable and long lasting. All replaceable parts are field serviceable. Spare parts are identified in the illustrated parts list.

Since the Little Anne manikin is easy to disassemble and reassemble, all repairs can be accomplished by the manikin's owner. Should a problem ever occur, however, we will be glad to assist you.

Introduction

Little Anne

Little Anne has been developed to provide a cost effective alternative for CPR training programs. More manikins can be used in the classroom, increasing hands-on practice and active participation for the students. All necessary educational requirements have been maintained to assure quality training.

Each Little Anne model simulates an adult of average physiology and anatomy and is designed for realistic training of basic life support skills, primarily cardiopulmonary resuscitation (CPR).

Features included are:

- Natural obstruction of the airway
- Realistic facial features and a movable jaw
- Realistic compliance for ventilations and compressions
- Chest rise and fall with proper ventilations
- Realistic landmarks for compression point location
- Audible confirmation of correct compression depth
- Carrying bag opens into a training mat.

AED Little Anne

The AED Little Anne was developed to work in combination with the Laerdal or Heartstream brand AED Trainer 2 device as a complete training system. Laerdal Link Technology, in the AED Little Anne Training System, requires the student to properly place the training pads on the manikin chest before the AED Trainer 2 will proceed through the selected scenario. If pads are improperly placed, the AED Trainer 2 will respond with the appropriate voice prompts. This is accomplished with no visible connectors on the chest skin. The AED Little Anne also has LED's in the chest skin indicating the center of correct pad placement. The LED lights up automatically when pads are attached correctly. If an electrode is loose or incorrectly placed on the manikin, the AED Trainer 2 will repeat the voice prompt to apply the electrode pads.

Note: For use with the AED Little Anne manikin with Laerdal Link Technology, electrode training pads with a white connector must be used (these electrodes are also marked with the Laerdal Link Technology logo).



Additional features for AED Little Anne are:

- Sensors in the chest skin detect proper pad placement
- Pad placement feedback provided by LED's in the chest skin.



Instructions for use

Remove the carrying bag from the plastic bag. Open the bag and lay it flat on the floor. This will now serve as a training mat. Little Anne is delivered fully assembled and ready for use.

Unpacking

Some additional supplies are provided for your convenience. Included with your Little Anne / AED Little Anne manikin (cat. No. 02 00 20, 02 00 25 or 02 00 50) are:

- Little Anne with Compression Clicker
- 1 extra Resusci Manikin Face
- 1 extra Little Anne Airway
- Carrying Bag/Training Mat
- Hygiene solution for training manikins
- Directions for Use
- Jacket (AED Little Anne only)

Using the compression clicker

Little Anne is supplied with a compression clicker that will confirm correct compression depth. When the clicker is "on", the student will hear a "click" when the torso is compressed 1 1/2 inches (38 mm).

To use the clicker
The manikin is delivered with the clicker in the "on" (inner) position.

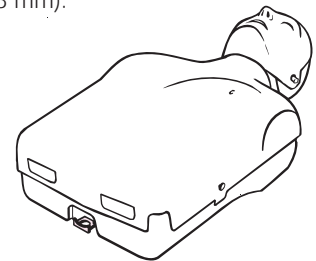

To disable the clicker
Pull out the clicker lever.

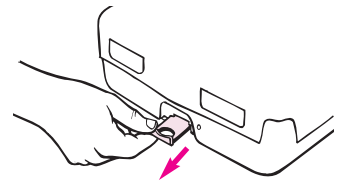

Note: Always push the clicker lever to the "On"-position before repacking the manikin.

SANITATION

During class

We recommend you provide an individual Manikin Face to each student. This eliminates the need for decontamination between students. All students can also use one face permanently installed on the manikin and disinfect the face between each student's use.

Using the Resusci Manikin Face on an individual basis

Each student in the class should install and remove his or her manikin face.

To remove

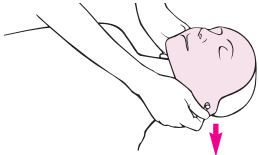

Detach manikin face from retainers at each ear.

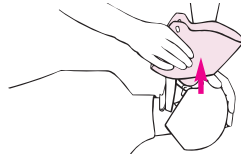

Lift manikin face off valve coupling.

To install

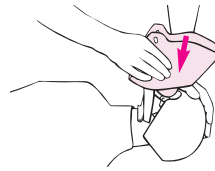

Turn manikin face inside out and push face coupling into airway valve. Push face coupling into airway connector until fully seated.

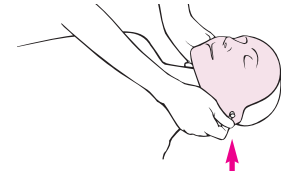

Fasten manikin face to retainers at each ear.

Using the same Resusci Manikin Face for all students

If several students are using the same manikin face, thorough disinfection between students is required.

Laerdal High Level Manikin Disinfectant

Laerdal High Level Manikin Disinfectant (Virkon) Rapid Pack make disinfection practical. Fill the 100ml bottle with luke warm water, open sachet and add Virkon to water. Leave for 2 minutes. Push cap firmly onto the bottle until it clicks. Shake bottle gently to ensure Virkon is fully dissolved.

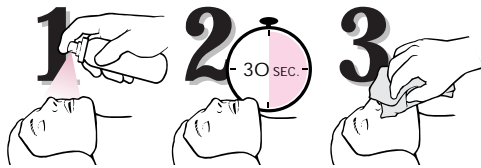

Spray manikin surface (mouth and nose area) until fully wetted (6-8 sprays). Do not allow Virkon to run off surfaces. Leave for 30 seconds and wipe thoroughly with a disposable cloth until dry. Ventilation practice may now continue.

Note: Depending on local policies you may prefer to use Resusci Manikin Wipes (see below) for cleaning or a freshly prepared sodium hypochlorite solution, but other procedures must then be followed.

To use Manikin Wipes

Tear foil packet open. Take out and unfold wipe. Rub manikin's mouth and nose vigorously. Wrap wipe snugly over mouth and nose.



Let stay in place for 30 sec.

Dry manikin's face with a clean paper towel or similar. Ventilation practice may now continue.

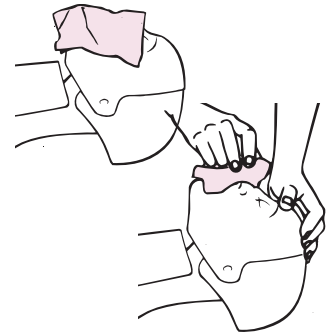

Manikin Face Shields (optional)

Proper disinfection of manikin's face provides proper hygienic conditions during training. However, for aesthetic reasons students may feel more comfortable having a clean barrier between own lips and surfaces touched by another person's lips. The Manikin Face Shields are designed to allow inexpensive barrier protection and to train the use of Laerdal Patient Face Shields made for use in real cases.

To use

Disinfect as instructed above. Pull a shield out of the roll and tear off at perforation. Place shield over manikin's face as illustrated.

Hold shield in place and airway open, as illustrated. Place your lips over the ventilation opening, pinch the nose, and ventilate. Discard shield after each practice session.

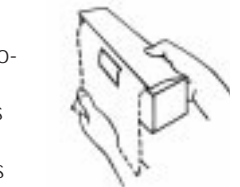

After class

Disinfection:

Preparing the Resusci Manikin Face for reuse

Laerdal High Level Manikin Disinfectant*

Note: Wear gloves** during cleaning.

1. Remove face and detach the coupling from inside the face.
2. Clean and disinfect faces and couplings as follows:

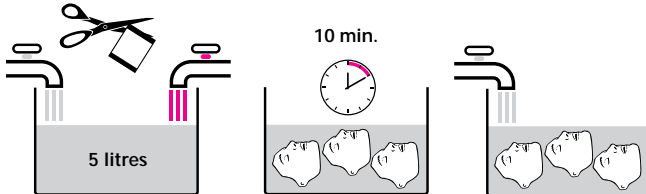
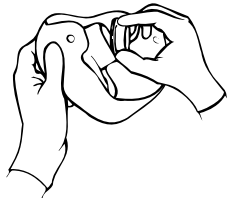

- a) Use a 50g sachet of Laerdal High Level Manikin Disinfectant (Virkon) which is enough for 5 litres of water (1% solution).
 - b) Immerse all components into the solution.
 - c) Scrub stubborn stains where necessary and leave for 10 minutes.
 - d) Rinse with fresh water.
3. Allow parts to dry.
 4. Reassemble face coupling and face skin.
 5. Remount face on manikin after reinstallation of airway or put in a clean bag for future use.

* Depending on local policies you may prefer to another manikin disinfectant solution, e.g. a freshly prepared sodium hypochlorite solution, but other procedures must then be followed.

** Vinyl gloves are recommended as latex gloves may stain face mask.

Little Anne Airway

The Little Anne Airway is designed for disposal after each class

A special exhaust filter prevents expired air moisture from being expelled from the airway.

To remove

1. Detach manikin face at each ear.
2. Lift manikin face off valve coupling.
3. Remove jaw from posts in head.
4. Remove valve.
5. Open chest cover.
6. Remove used airway and discard.

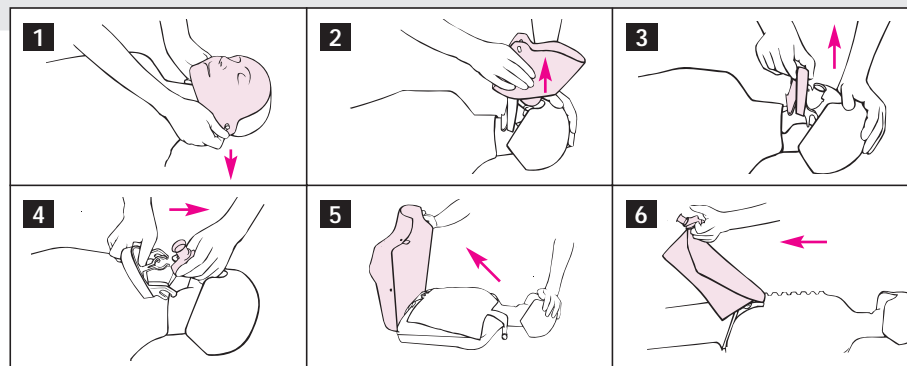

To install

1. Lay lung flat on torso and attach to hook.
2. Snap airway valve onto jaw.
3. Reattach jaw to posts in head.
4. Fasten chest cover onto the four retainers.
5. Push face coupling into airway valve.
6. Fasten face onto retainers at each ear.

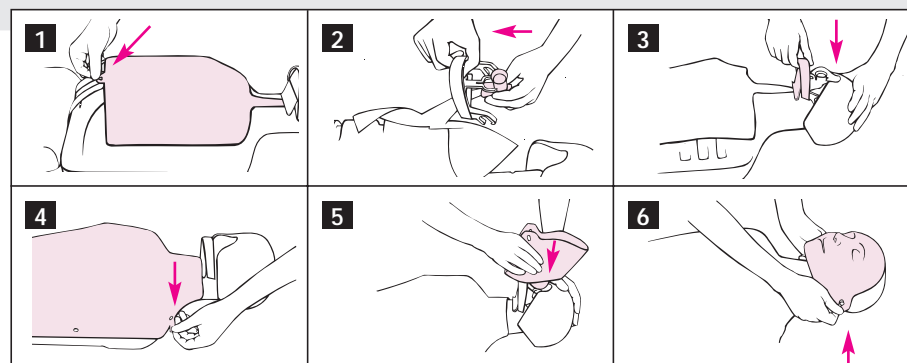

Maintenance

General manikin cleaning

Routine disinfection of the entire manikin is not required, but periodic cleaning of the head, torso, top skin, and training mat is recommended. These should be washed with a warm soapy solution, and then rinsed with a clean damp cloth. Proper care will maintain the appearance and general condition of your Little Anne.

Miscellaneous replacements

To change clicker

To remove

Open the chest cover.
Remove the rib plate.
Set the clicker in the "off" position (outer position).

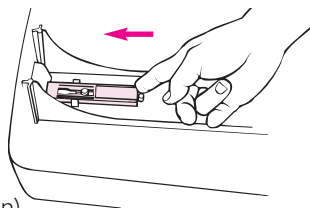

Press together the sides of the clicker and lift it up. Push it out through the opening in the torso.

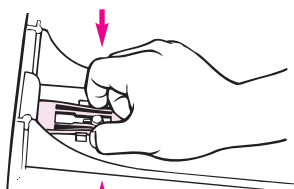

To install

Insert the clicker from outside (with the pad facing upward). Press the clicker down until it snaps into place.

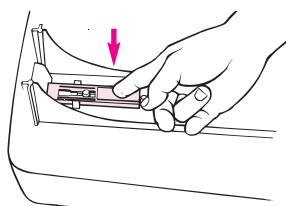

To change clicker activator

The clicker activator is located underneath the rib plate. It is fastened by snapping it in place over the edge and into the two holes of the rib plate as illustrated.

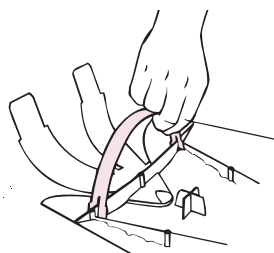

To change chest skin

Unhook the chest skin from its retainers.

Note: For the AED Little Anne model be aware of wires connecting the chest skin to the battery box under the rib plate. Disconnect the two wires from the battery box (when connecting the new chest skin wires to the battery box it does not matter which wire goes to which socket).

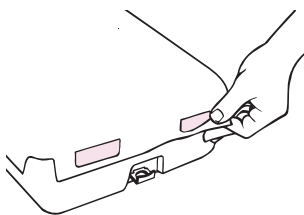

To change head

To remove

When face, airway and jaw have been removed (described in "After class"), flex the lower edges of the head outward until the head can be removed.

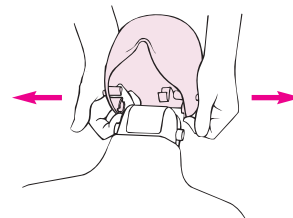

To install

Grasp the manikin head with both hands, with your fingers on the inside of the head. Gently pull outwards and slide the head onto the neck posts, one side at a time.

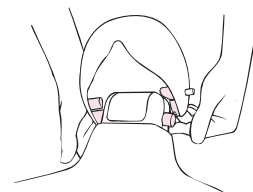

To install the airway, face and jaw, see page 5.

AED Little Anne only

To change battery

AED Little Anne comes with a standard alkaline 6LF22 / 6LR61 9 Volt battery.

- Open the chest skin.
 - Note:** Be aware of wires connecting the chest skin to the battery box under the rib plate.
- Remove the old battery and install a new 9 Volt alkaline battery. Be sure to follow the positive (+) and negative (-) battery icons etched into the inside of the battery holder when inserting new battery.

Battery low indicators

- Depressing the test button on the battery board will illuminate the LED's in the chest skin if battery strength is sufficient for operation. If the LED's do not light when the button is depressed a new battery is required.
- A "Battery low" voice prompt from the AED Trainer 2 will be heard immediately after connecting Laerdal Link training pads if the manikin battery is low.



Parts

- Models**
- 02 00 20 Little Anne
- 02 00 25 Little Anne, w/dark skin
- 02 00 50 AED Little Anne
- Parts**
- 02 01 10 Back section
- 02 01 20 Rib plate
- 02 10 00 Chest cover
- 02 10 05 Chest cover w/dark skin
- 02 05 10 Compression spring
- 02 01 11 Compression clicker
- 02 01 12 Clicker activator
- 02 02 00 Head complete
- 02 02 01 Jaw assembly
- 02 02 02 Head assembly
- 02 06 10 Directions for Use
- 02 07 00 Carrying bag

Accessories

- 02 03 00 Airways complete, pkg. of 24
- 02 03 01 Airways complete, pkg. of 96
- 02 03 10 Valves complete, pkg. of 50
- 02 03 11 Filter & Lung, pkg. of 100
- 15 20 04 Manikin Faces, pkg. of 6
- 15 20 08 Manikin Faces, dark skin, pkg. of 6
- 15 42 00 Manikin Disinfectant Terminal (10x50g)
- 15 42 20 Manikin Disinfectant Rapid (3g + bottle)
- 15 24 00 Resusci Manikin Wipes, pkg. of 50
- 15 24 01 Resusci Manikin Wipes, pkg. of 1200
- 15 12 01 Manikin Face Shields, 6 rolls of 36 ea.

Additional parts for AED Little Anne only:

- 02 50 10 Battery board
- 02 50 15 AED Chest skin
- 02 50 30 Soft pack, AED Little Anne, Blue
- 02 50 20 Jacket, AED Little Anne

- 94 50 90 Training Pads, Laerdal Link Training System

For customers of Philips Medical Systems Heartstream, please contact your sales representative or call 1 (800) 263-3342 for ordering information.

Product specifications are subject to change without notice.

CE This product is in compliance with the essential requirements of Council Directive 89 / 336 / EEC; EMC Directive.